

The Fern Orchard View

2-bedroom home, sleeps 4

2 | 

1 | 

1 | 



Artist's impression

Key features

- Two double bedrooms
- Downstairs W.C.
- Three-piece bathroom suite
- Open plan kitchen and dining room
- Separate living room
- Driveway parking



The Fern
Available plots
Rent to Buy
15, 53
Outright Sale
17, 63, 65

Hargreaves Road, Northwich, CW9 7BL

A selection of 2, 3 & 4-bedroom houses and 1-bedroom apartments

The Fern Orchard View

2-bedroom home, sleeps 4

Ground floor



First floor

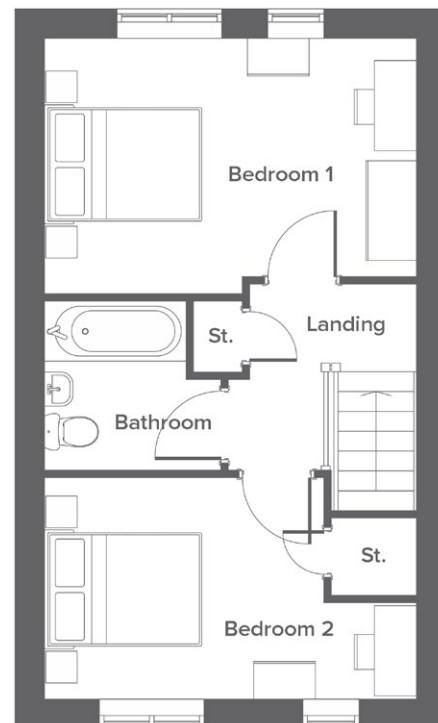

Room	Metric	Imperial	Room	Metric	Imperial
Kitchen/Dining	2.4 x 4.7	7'10" x 15'7"	Bedroom 1	4.5 x 3.1	14'11" x 10'2"
Lounge	4.5 x 3.2	14'11" x 10'6"	Bedroom 2	4.5 x 2.7	14'11" x 8'11"
W.C.	0.9 x 1.6	3'1" x 5'6"	Bathroom	2.1 x 2.0	7'1" x 6'8"

Total size **70.88 m² / 763 ft²**

Get in touch

 01606 218072

 [yourhousinggroup.co.uk](https://www.yourhousinggroup.co.uk)

 @yourhousing

 yourhousinggroup